

**EB, EBH, EC, ECH, ECHL, ECP, ECS, ECSP, PC, PCH,  
 EC2, ECH2, ECP2, ECS2, ECSP2, ECHL2**

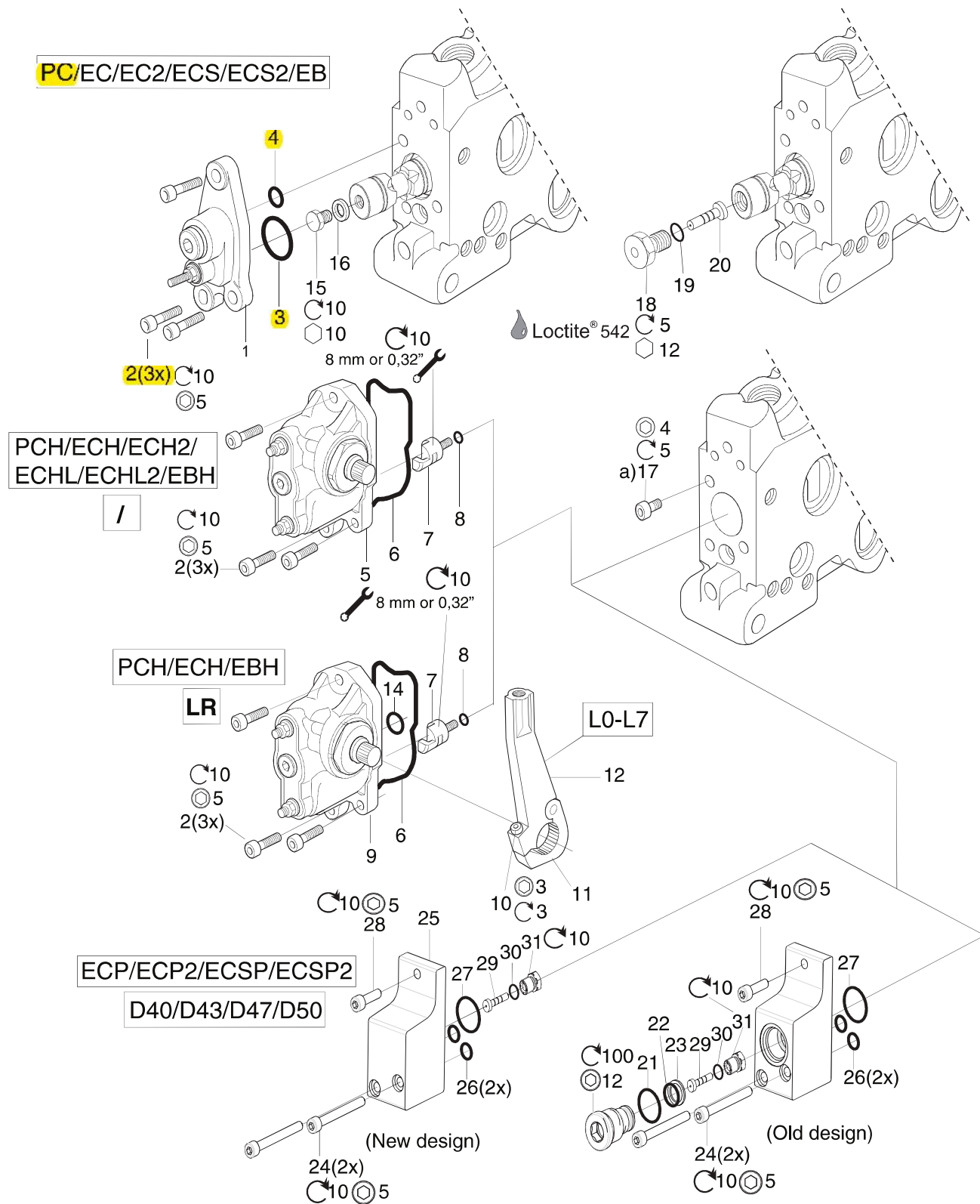

See Customer Specification				
Code	Pos	Part	Description	Remarks / Items
EC, ECS, EB, <b>PC</b> , EC2, ECS2 + G	50 + 04	<b>393000K337</b>	<b>Cap kit, BSP</b>	<b>1, 2(3x), 3, 4</b>
EC, ECS, EB, PC, EC2, ECS2 + U	50 + 04	393000K338	Cap kit, UNF	1, 2(3x), 3, 4
A016 + G	50 + 04	393000K746	Cover kit, BSP	Not shown
A016 + U	50 + 04	393000K747	Cover kit, UNF	Not shown
	-	6760774	Seal kit, BSP	Pls see Appendix B
	-	6760685	Seal kit, UNF	Pls see Appendix B
ECH*, EBH, PCH, CH + / + G	50 + 52 + 04	6760606	Lever housing kit (BSP)	2(3x), 5, 6, 7, 8, 17 <b>a)</b>
ECH*, EBH, PCH, VH + / + U	50 + 52 + 04	6763395	Lever housing kit (UNF)	2(3x), 5, 6, 7, 8, 17 <b>a)</b>
ECH*, EBH, PCH, CH	-	6760775	Seal kit, BSP	Pls see Appendix B
ECH*, EBH, PCH, CH	-	6760625	Seal kit, UNF	Pls see Appendix B
ECH, EBH, PCH + LR + G	50 + 52 + 04	393000K419	Lever housing kit (BSP)	2(3x), 6, 7, 8, 9, 14
ECH, EBH, PCH + LR + U	50 + 52 + 04	393000K420	Lever housing kit (UNF)	2(3x), 6, 7, 8, 9, 14
ECH, EBH, PCH + LR	-	6760809	Seal kit	Pls see Appendix B
ECH, EBH, PCH + /	-	6760810	Seal kit	Pls see Appendix B
ECH, EBH, PCH + /	-	6760812	Seal kit	Pls see Appendix B
L0 - L7	51	393000K344	Lever kit	10, 11, 12
Closed spools	60	6760663	Screw kit	15, 16 <b>b)</b>
D2, D2T, D2X, EA2	60	393000K901	Mech. Force feedback pin	18, 19, 20
ECP, ECP2, ECSP, ECSP2 + Dxx	50 + 52	6760233	Cap kit on A- side	24(2x), 25, 26(2x), 27, 28
ECP, ECP2, ECSP, ECSP2 + D35	50 + 52	6763323	Pin kit D35	29, 30, 31
ECP, ECP2, ECSP, ECSP2 + D40	50 + 52	6763105	Pin kit D40	29, 30, 31
ECP, ECP2, ECSP, ECSP2 + D43	50 + 52	6763106	Pin kit D43	29, 30, 31
ECP, ECP2, ECSP, ECSP2 + D47	50 + 52	6763107	Pin kit D47	29, 30, 31
ECP, ECP2, ECSP, ECSP2 + D50	50 + 52	6763108	Pin kit D50	29, 30, 31
ECP, ECP2, ECSP, ECSP2	50	6760236	Seal kit (old design)	21, 22, 23, 26(2x), 27
ECP, ECP2, ECSP, ECSP2	50	6763100	Seal kit (new design)	26(2x), 27

a) Screw item 17 has expired from Serial No. 0622... (machining for M5 hole does not exist any more).

b) Not for spool functions D2, D2T, D2X, EA2 and DP, MP, EAP.